

# TH211-210 Salter St. New Westminster, BC

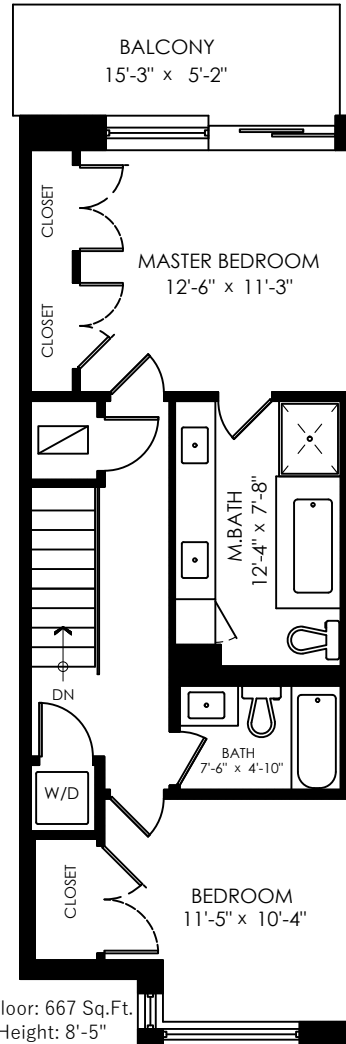

Main Floor	667 SQ.FT.
Upper Floor	667 SQ.FT.
<b>Total</b>	<b>1334 SQ.FT.</b>

Patio	250 SQ.FT.
Balcony	79 SQ.FT.
<b>Total Extras</b>	<b>329 SQ.FT.</b>

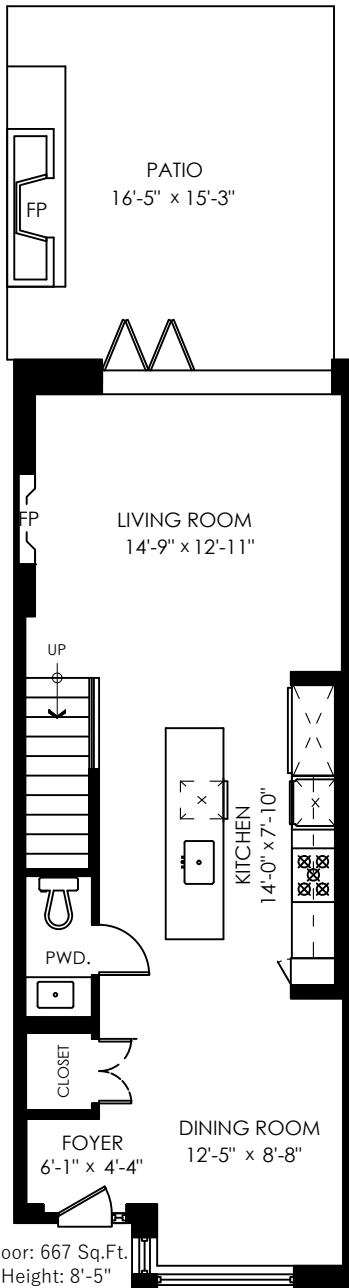